

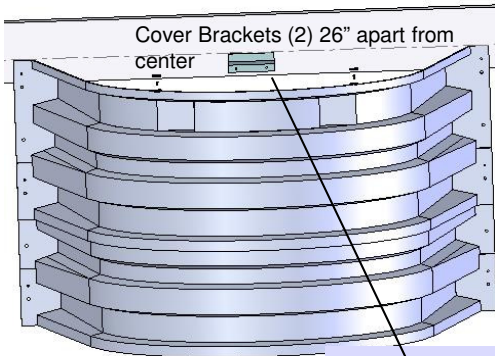

Stonewell Egress Window Well Cover Installation Instructions

StoneWell Egress
Cover



StoneWell Egress Well

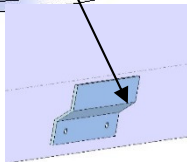

ADHESIVE SIDE UP



Velcro™ Square



Stainless Steel Screw



4 - Dual Lock™ Washers

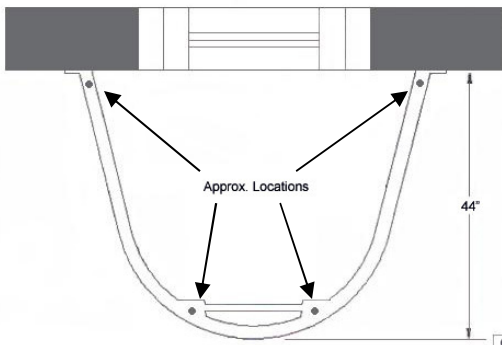

Step 1

Acquire (4) anchor-bolts for concrete or screws/ bolts for wood at least 2-1/2" long and 1/8" diameter to secure the Cover Brackets to the House Wall.

Step 2 – Mounting Cover Bracket

Draw a line on the House Wall across the top of the Egress Well. Place one Cover Bracket immediately below the line and 13" left of center of egress with the holes of the bracket up against the House Wall. Use the Cover Bracket as a template and mark the two holes on the wall. Check that the holes are 2" below the line and 14" & 18" left of center. Repeat w/ right Cover Bracket.

Step 3

Drill the (4) holes and mount the Cover Brackets to the wall using the (4) anchor/screws you acquired per Step 1.

Step 4

Locate positions for the (4) Dual Lock Washers. Position the front (2) washers over the vertical supports-about 30" apart and on the top ledge of the Egress. Position the rear (2) washers 3"-4" out from the House Wall. Drill 1/16" diameter hole towards the front edge of the top ledge of the Egress (4) places. (See picture at lower left of page form approximate locations of front two Velcro).

Step 5 – Secure Cover to Well

Using a screw driver run the Stainless Steel Screws through the drilled 1/16" diameter holes and the Dual Lock Washers (washer teeth upward) and secure to well.

Step 6

Center the Velcro™ squares onto the Dual Lock™ Washers with adhesive sides away from washer. Then remove backing papers from adhesives on squares and bring lid down slowly until firm contact is maintained between egress cover and adhesive of the Velcro™ squares.

NOTE: The weather should be neither COLD nor WET when applying the adhesive squares in Step #6.

NOTE: Egress Cover may be cleaned with mild soap and water. Use of harsh chemicals should be avoided. Use cleaners appropriate for polycarbonate only.